

LUTHUN LLC
432 E 13TH STREET
NEW YORK NY 10009

MANHATTAN COMMUNITY BOARD 3

Meeting Date: 3/18/2019

SLA Application for a Beer and Wine License



THE CITY OF NEW YORK MANHATTAN COMMUNITY BOARD 3

59 East 4th Street - New York, NY 10003
Phone (212) 533-5300
www.cb3manhattan.org - info@cb3manhattan.org

Alysha Lewis-Coleman, Board Chair

Susan Stetzer, District Manager

Community Board 3 Liquor License Application Questionnaire

Please bring the following items to the meeting:

NOTE: ALL ITEMS MUST BE SUBMITTED FOR APPLICATION TO BE CONSIDERED.

- Photographs of the inside and outside of the premise.
- Schematics, floor plans or architectural drawings of the inside of the premise.
- A proposed food and or drink menu.
- Petition in support of proposed business or change in business with signatures from residential tenants at location and in buildings adjacent to, across the street from and behind proposed location. Petition must give proposed hours and method of operation. For example: restaurant, sports bar, combination restaurant/bar. (petition provided)
- Notice of proposed business to block or tenant association if one exists. You can find community groups and contact information on the CB 3 website:
http://www.nyc.gov/html/mancb3/html/communitygroups/community_group_listings.shtml
- Proof of conspicuous posting of notices at the site for 7 days prior to the meeting (please include newspaper with date in photo or a timestamped photo).

Check which you are applying for:

- new liquor license alteration of an existing liquor license corporate change

BEER AND WINE LICENSE

Check if either of these apply:

- sale of assets upgrade (change of class) of an existing liquor license

Today's Date: 2/20/2019

If applying for sale of assets, you must bring letter from current owner confirming that you are buying business or have the seller come with you to the meeting.

Is location currently licensed? Yes No Type of license: 2 OP LICENSES

If alteration, describe nature of alteration: _____

Previous or current use of the location: RESTAURANT

Corporation and trade name of current license: KAITO CORP AND GHD INC (NEXT DOOR)

APPLICANT:

Premise address: 432 E 13TH STREET NEW YORK NY 10009

Cross streets: 1ST AVENUE AND AVENUE A

Name of applicant and all principals: LUTHUN LLC-ARJUNA BULL, NAHID AHMED, LUCAS SZEWS

Trade name (DBA): LUTHUN

PREMISE:

Type of building and number of floors: MIXED - COMMERCIAL ON GRND FL & 5 RESIDENTIAL FLRS ABOVE

Will any outside area or sidewalk cafe be used for the sale or consumption of alcoholic beverages?
(includes roof & yard) Yes No If Yes, describe and show on diagram: N/A

Does premise have a valid Certificate of Occupancy and all appropriate permits, including for any
back or side yard use? Yes No What is maximum NUMBER of people permitted? 74

Do you plan to apply for Public Assembly permit? Yes No

What is the zoning designation (check zoning using map: <http://gis.nyc.gov/doitt/nycitymap/> -
please give specific zoning designation, such as R8 or C2):

R8B

PROPOSED METHOD OF OPERATION:

Will any other business besides food or alcohol service be conducted at premise? Yes No

If yes, please describe what type: N/A

What are the proposed days/hours of operation? (Specify days and hours each day and hours of
outdoor space) MONDAY - SATURDAY 5:00PM - 1:00AM - THE LAST SEATING WILL BE AT 10:00PM

Number of tables? 8 Total number of seats? 18

How many stand-up bars/ bar seats are located on the premise? 9

(A **stand up bar** is any bar or counter (whether with seating or not) over which a patron can order,
pay for and receive an alcoholic beverage)

Describe all bars (length, shape and location): L SHAPE, APPROXIMATELY 15 FEET

Does premise have a full kitchen Yes No?

Does it have a food preparation area? Yes No (If any, show on diagram)

Is food available for sale? Yes No If yes, describe type of food and submit a menu

TASTING MENU - WILL CHANGE REGULARLY BASED ON SEASONAL ITEMS (6-8 COURSES)

What are the hours kitchen will be open? 5:00 - 1:00AM

Will a manager or principal always be on site? Yes No If yes, which? ARJUNA & NAHID

How many employees will there be? 8-10

Do you have or plan to install French doors accordion doors or windows?

Will there be TVs/monitors? Yes No (If Yes, how many?) _____

Will premise have music? Yes No

If Yes, what type of music? Live musician DJ Juke box Tapes/CDs/iPod

If other type, please describe _____

What will be the music volume? Background (quiet) Entertainment level

Please describe your sound system: IPOD AND 3 SMALL SPEAKERS _____

Will you host any promoted events, scheduled performances or any event at which a cover fee is charged? If Yes, what type of events or performances are proposed and how often? NO

How do you plan to manage vehicular traffic and crowds on the sidewalk caused by your establishment? Please attach plans. (Please do not answer "we do not anticipate congestion.")

Will there be security personnel? Yes No (If Yes, how many and when) _____

How do you plan to manage noise inside and outside your business so neighbors will not be affected? Please attach plans.

Do you have sound proofing installed? Yes No
If not, do you plan to install sound-proofing? Yes No

APPLICANT HISTORY:

Has this corporation or any principal been licensed previously? Yes No

If yes, please indicate name of establishment: _____

Address: _____ Community Board # _____

Dates of operation: _____

Has any principal had work experience similar to the proposed business? Yes No If Yes, please attach explanation of experience or resume.

Does any principal have other businesses in this area? Yes No If Yes, please give trade name and describe type of business _____

Has any principal had SLA reports or action within the past 3 years? Yes No If Yes, attach list of violations and dates of violations and outcomes, if any.

Attach a separate diagram that indicates the location **(name and address)** and total number of establishments selling/serving beer, wine (B/W) or liquor (OP) for 2 blocks in each direction. Please indicate whether establishments have On-Premise (OP) licenses. Please label streets and avenues and identify your location. Use letters to indicate **Bar, Restaurant, etc.** The diagram must be submitted with the questionnaire to the Community Board before the meeting.

LOCATION:

How many licensed establishments are within 1 block? 8

How many On-Premise (OP) liquor licenses are within 500 feet? 13 (PER LAMP DATED 2/19)

Is premise within 200 feet of any school or place of worship? Yes No

COMMUNITY OUTREACH:

Please see the Community Board website to find block associations or tenant associations in the immediate vicinity of your location for community outreach. Applicants are encouraged to reach out to community groups. Also use provided petitions, which clearly state the name, address, license for which you are applying, and the hours and method of operation of your establishment at the top of each page. (Attach additional sheets of paper as necessary).

We are including the following questions to be able to prepare stipulations and have the meeting be faster and more efficient. Please answer per your business plan; do not plan to negotiate at the meeting.

1. I will operate a full-service restaurant, specifically a (type of restaurant) GLOBAL TASTING MENU, CHEF DRIVEN RESTAURANT, with a kitchen open and serving food during all hours of operation OR I have less than full-service kitchen but will serve food all hours of operation.
2. I will close any front or rear façade doors and windows at 10:00 P.M. every night or when amplified sound is playing, including but not limited to DJs, live music and live nonmusical performances.
3. I will not have DJs, live music, promoted events, any event at which a cover fee is charged, scheduled performances, more than _____ DJs / promoted events per _____, more than 12 private parties per YEAR.
4. I will play ambient recorded background music only.
5. I will not apply for an alteration to the method of operation or for any physical alterations of any nature without first coming before CB 3.
6. I will not seek a change in class to a full on-premise liquor license without first obtaining approval from CB 3.
7. I will not participate in pub crawls or have party buses come to my establishment.
8. I will not have a happy hour or drink specials with or without time restrictions OR I will have happy hour and it will end by _____.
9. I will not have wait lines outside. I will have a staff person responsible for ensuring no loitering, noise or crowds outside.
10. Residents may contact the manager/owner at the number below. Any complaints will be addressed immediately. I will revisit the above-stated method of operation if necessary in order to minimize my establishment's impact on my neighbors.

LUTHUN

Amuse

Seaweed Tartlet, Summer Vegetables

1st

Trout Roe, Mango Custard, Puffed Rice

2nd

Carrots, Sea Buckthorn, Goats Milk Caramel

3rd

Porridge, Aromatic Rice, Young Coconut

4th

Monkfish, Green Curry, Jackfruit Emulsion

5th

Dry Aged Lamb, Anchovy, Burnt Eggplant

Dessert

Szechuan Peppercorn Ice Cream, Semi-Dried Raspberries

Tasting Menu \$68

Wine Pairing \$50

Wines by the Glass \$14

Wine Bottles \$48 - \$200

432 E 13th Street
New York, NY 10009

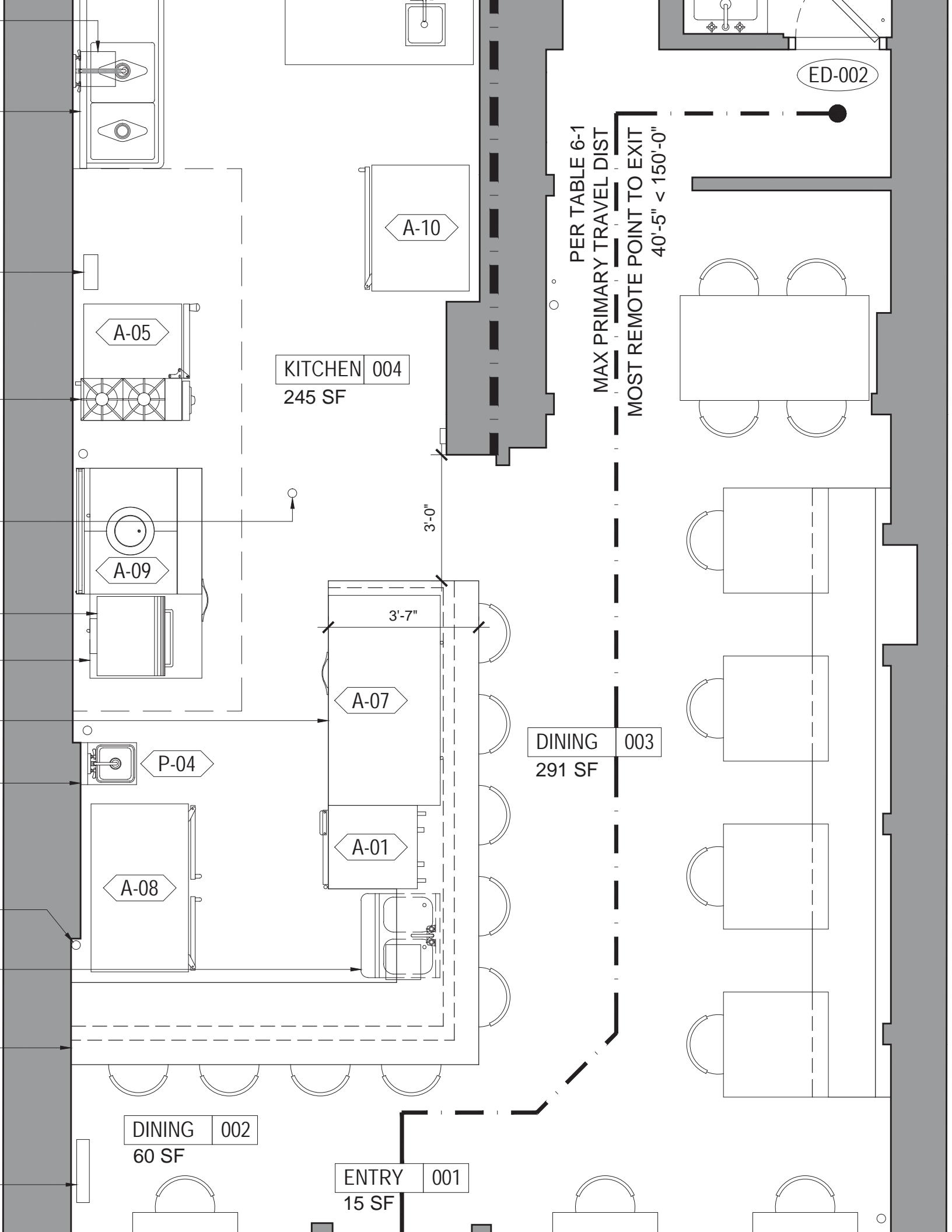

ED-002

PER TABLE 6-1
 MAX PRIMARY TRAVEL DIST
 MOST REMOTE POINT TO EXIT
 40'-5" < 150'-0"

KITCHEN 004
 245 SF

DINING 003
 291 SF

DINING 002
 60 SF

ENTRY 001
 15 SF

A-05

A-09

P-04

A-08

A-07

A-01

A-10

3'-0"

3'-7"

4

Photo of Outside of Building (Google photo):



432

VENTED RESTAURANT
FOR LEASE
NO KEY MONEY - FULLY EQUIPPED
FULL LIQUOR LICENSE

STEVE RAPPAPORT
646.673.8750 STEVE@SINVIN.COM

MARGIE SARWAY
646.673.8742 MARGIE@SINVIN.COM









Google Map of Area:

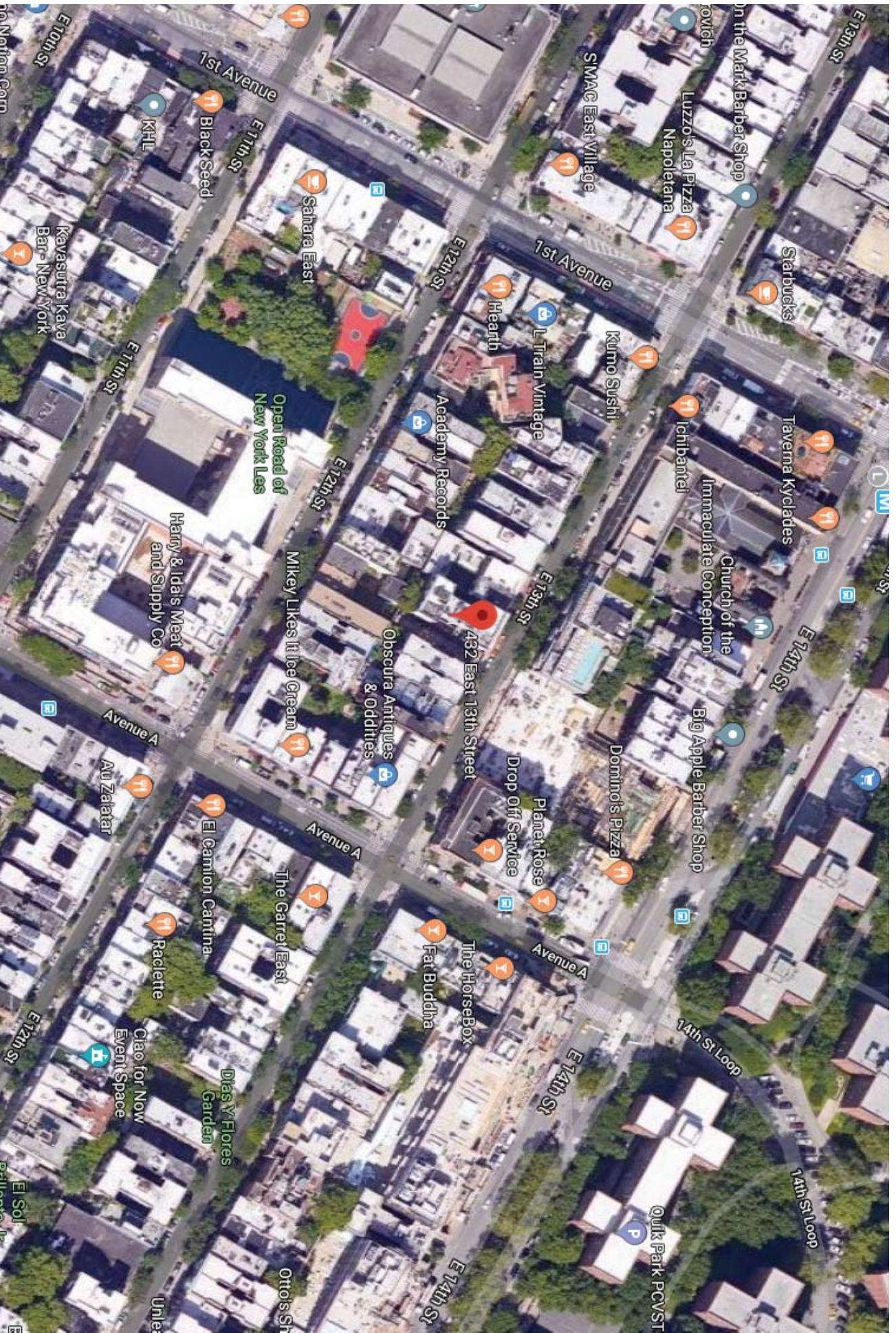

500 FOOT MAP OF AREA (PER LAMP REPORT):



- BLUE STAR: PREMISE
- BLUE LINE: MARKS 500 FEET
- RED DOT: OP LICENSES
- RED TRIANGLE: BEER AND WINE LICENSE
- BLACK DIAMOND: CHURCH
- YELLOW FLAG: SCHOOL

Proximity Report for Location:

February 19, 2019

432 E 13 St, New York, NY, 10009

* This report is for informational purposes only in aid of identifying establishments potentially subject to 500 and 200 foot rules. Distances are approximated using industry standard GIS techniques and do not reflect actual distances between points of entry. The NYS Liquor Authority makes no representation as to the accuracy of the information and disclaims any liability for errors.

Closest Liquor Stores

Name	Address	Approx. Distance
HANA WINE & LIQUOR INC	28 WYCKOFF AVE	1155 ft
P & G NORTHERN LIQUOR & WINE INC	47-05 METROPOLITAN AVE	1795 ft
SONG'S FAMILY LIQUOR INC	202 KNICKERBOCKER AVE	2330 ft
COMMISSARY VENTURES LLC	1544 DEKALB AVE	2480 ft
325 DISCOUNT LIQUOR & WINE CORP	325 KNICKERBOCKER AVE	2925 ft
NEW WILSON LIQUOR INC	14 WILSON AVE	2985 ft
B&S WINE AND SPIRITS INC	152 WYCKOFF AVE	3000 ft
CONVIVE PARTNERS LLC	196 AVENUE A	370 ft
CARMAD INC	224 226 1ST AVE	400 ft
236 WINES & LIQUORS INC	279 1ST AVENUE	970 ft
WINESHOP LLC	438 A E 9TH ST	1035 ft
BEE WINES & LIQUORS INC	225 AVENUE B	1070 ft
BRIX NYC LLC	170 AVENUE B	1155 ft
EAST VILLAGE WINES & SPIRITS INC	138 1ST AVE	1180 ft

Churches within 500 Feet

Name	Approx. Distance
Grace Chapel and Dispensary	330 ft
Immaculate Conception Church	330 ft

Schools within 500 Feet

Name	Address	Approx. Distance
LEARNING PROJECT	420 E 12TH ST	360 ft
EAST SIDE COMM HS	420 E 12TH ST	360 ft

On-Premise Licenses within 750 Feet

Name	Address	Approx. Distance
KAITO CORP	432 E 13TH ST	55 ft
GHD INC	432 E 13TH STREET, WEST STORE	175 ft
TAVERN 211 CORP	211 AVENUE A	210 ft
HUGHES MURRAY WALSH LLC	447 E 13TH ST	215 ft
FRIDA & DIEGO CORP	211 AVENUE A	250 ft
FAT PANDA INC	219 AVENUE A NORTH	295 ft
DBW RESTAURANT ASSOCIATES LLC	206 AVE A	340 ft

Name	Address	Approx. Distance
LO ENG INC	212 AVENUE A	345 ft
HORSEBOX INC	218 AVENUE A	370 ft
MONOLITH INC	194 AVE A	380 ft
HEARTH RESTAURANT INVESTORS LLC	403 E 12TH ST	400 ft
MACCG LLC	228 1ST AVE	410 ft
1862 HOSPITALITY LLC	503 505 E 12TH ST	425 ft
FIRST E V PIZZA INC	211 1ST AVE	470 ft
BEEP BEEP NYC LLC	201 1ST AVE	505 ft
EST RESTAURANT CORP	349 E 13TH ST	540 ft
PATTY MC CARTHYS INC	169 AVENUE A	630 ft
SPT CORP	538 E 14TH STREET	650 ft
ATS RESTAURANT CORP	349 E 14TH ST	670 ft
DELTA 510 CORP	510 E 11TH ST	725 ft
CGJC HOLDINGS LLC	168 1ST AVE	745 ft

Pending Licenses within 750 Feet

Name	Address	Approx. Distance
EAST VILLAGE DELI INC	217 AVENUE A	285 ft
AVE A HOSPITALITY LLC	200 AVENUE A	365 ft
TRUEVIAND LLC	171 AVENUE A	615 ft
DUA KAFE INC	520 E 14TH ST	700 ft

Unmapped licenses within zipcode of report location

Name	Address
------	---------

BLOCK PLOT DIAGRAM
432 E 13th Street

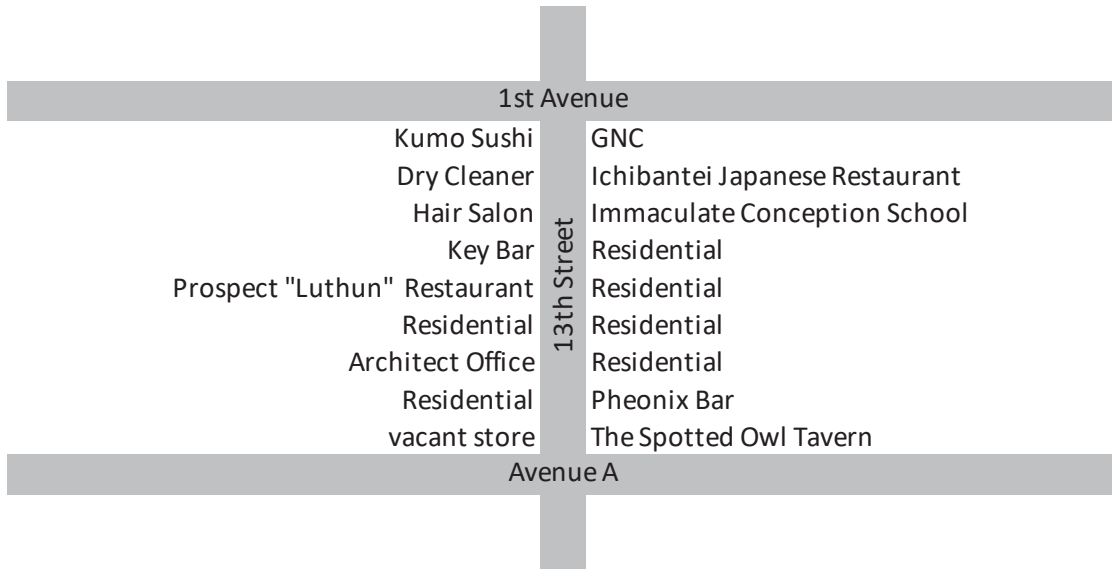



NEW YORK STATE LIQUOR AUTHORITY

DIVISION OF ALCOHOLIC
BEVERAGE CONTROL

Andrew M. Cuomo, Governor
Vincent G. Bradley, Chairman
Greeley T. Ford, Commissioner

[Home](#)

[Public License Query](#)

[Wholesale](#)



[Forms Quick-Find:](#)

[Wholesale Forms](#)

[Retail Forms](#)

[Help](#)

Public Query - Results

License Information

Serial Number: 1285245
License Type: ON-PREMISES LIQUOR
License Status: Expired
Credit Group: 2
Filing Date: 04/08/2015
Effective Date: 06/19/2015
Expiration Date: 05/31/2017

Premises Information

Principal's Name: KIMBARA, NOBUYOSHI
KOBAYASHI, NORIKO
OTOMO, TAKAAKI
Premises Name: KAITO CORP
Trade Name: TESHIGOTOYA
Zone: 1
Address: 432 E 13TH ST

NEW YORK, NY 10009
County: NEW YORK

You can select one of the following links to perform another search:

- [Search by Name](#)
- [Search by License Number](#)
- [Search by Location](#)
- [Search by Principal](#)
- [Advance Search](#)

[Disclaimers](#) | [Confidentiality](#) | [Privacy](#) | [Security](#)

New York State Liquor Authority • 80 S. Swan Street • 9th Floor • Albany, New York • 12210-8002



NEW YORK STATE LIQUOR AUTHORITY

DIVISION OF ALCOHOLIC
BEVERAGE CONTROL

Andrew M. Cuomo, Governor
Vincent G. Bradley, Chairman
Greeley T. Ford, Commissioner

[Home](#)

[Public License Query](#)

[Wholesale](#)



[Forms Quick-Find:](#)

[Wholesale Forms](#)

[Retail Forms](#)

[Help](#)

Public Query - Results

License Information

Serial Number: 1130571
License Type: ON-PREMISES LIQUOR
License Status: License is Active
Credit Group: 3
Filing Date: 07/01/2002
Effective Date: 09/01/2018
Expiration Date: 08/31/2020

Premises Information

Principal's Name: BERTOK, GYULA Z.
DRAVICZKI, ATTILA B.
Premises Name: GHD INC
Trade Name:
Zone: 1
Address: 432 E 13TH STREET, WEST STORE

NEW YORK, NY 10009
County: NEW YORK

You can select one of the following links to perform another search:

- [Search by Name](#)
- [Search by License Number](#)
- [Search by Location](#)
- [Search by Principal](#)
- [Advance Search](#)

[Disclaimers](#) | [Confidentiality](#) | [Privacy](#) | [Security](#)

New York State Liquor Authority • 80 S. Swan Street • 9th Floor • Albany, New York • 12210-8002